

Date: 6/20/23
Rev:
Drawn: CW
Sheet: 1 of 4

PRODUCT NAME

8' ALUMINUM PLANK TABLE

MODEL NO.

TPA-8A-SPEC

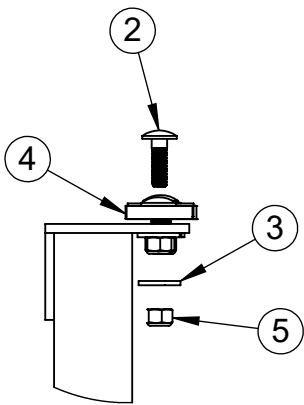
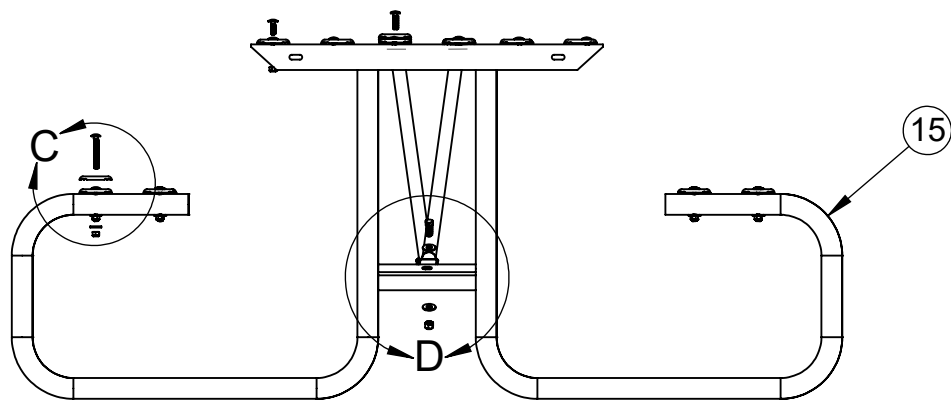
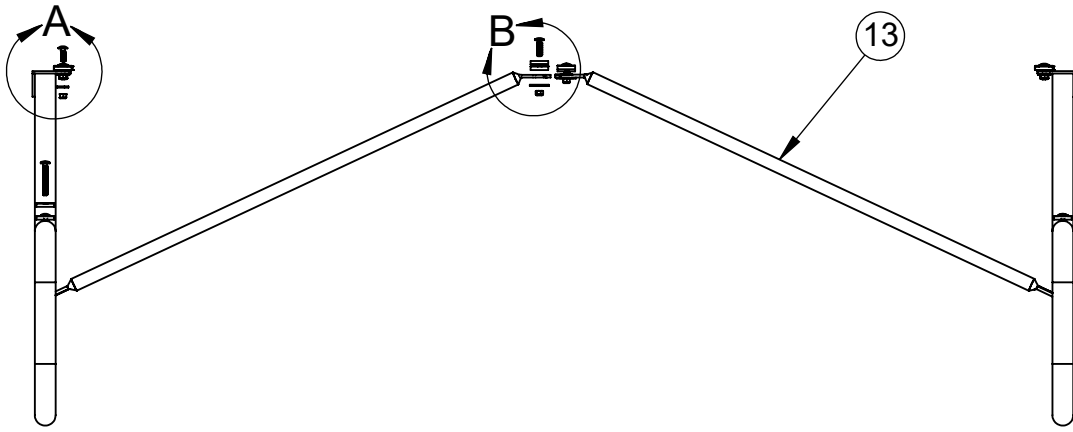

DETAIL A

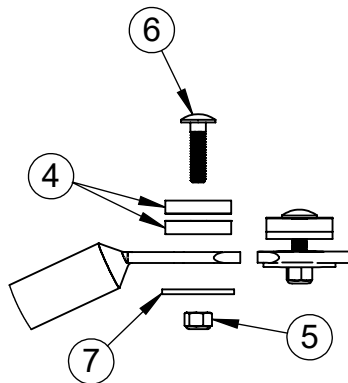

DETAIL B

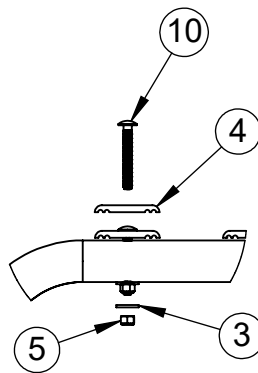

DETAIL C

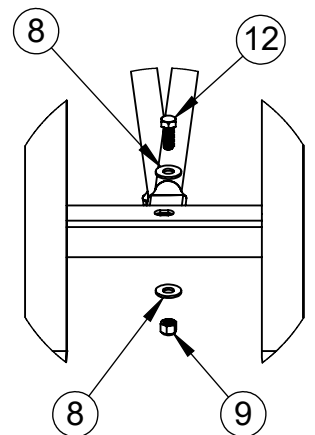

DETAIL D



Date: 6/20/23
Rev:
Drawn: CW
Sheet: 2 of 4

PRODUCT NAME

8' ALUMINUM PLANK TABLE

MODEL NO.

TPA-8A-SPEC

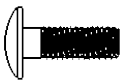

HWCB5161

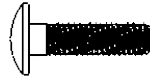

HWCB516114



HWCB516212

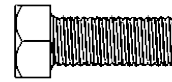

HWHB381

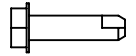

HWTEX1034

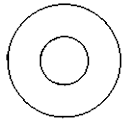

HWFLWA516/
HWFLWA38

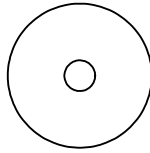

HWFW516



HWLN516

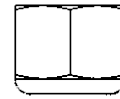

HWLN38

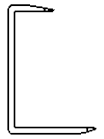

VCIAECP

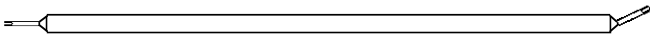

CIPICTAB8



RMPLK8-10TW

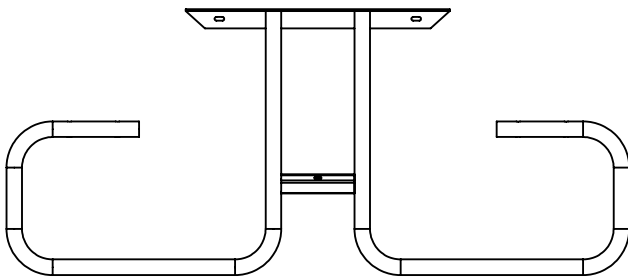

WTPAJFRAME

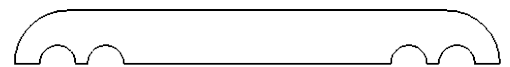

VCIACLP-TW



Date: 6/20/23
 Rev:
 Drawn: CW
 Sheet: 3 of 4

PRODUCT NAME
 8' ALUMINUM PLANK TABLE
 MODEL NO.
 TPA-8A-SPEC

| ITEM NO. | PART NUMBER | DESCRIPTION | QTY. |
|----------|-------------|---|------|
| 1 | RMPLK8-10TW | 2" x 8' ALUMINUM PLANK | 5 |
| 2 | HWCB5161 | 5/16"-18 x 1" CARRIAGE BOLT | 12 |
| 3 | HWFLWA516 | 5/16" USS FLAT WASHER | 20 |
| 4 | VCIACLP-TW | ALUMINUM PLANK CLIP | 24 |
| 5 | HWLN516 | 5/16"-18 LOCK NUT | 22 |
| 6 | HWCB516114 | 5/16"-18 x 1-1/4" CARRIAGE BOLT | 2 |
| 7 | HWFW516 | 5/16" X 1-1/2" FENDER WASHER | 2 |
| 8 | HWFLWA38 | 3/8" FLAT WASHER | 4 |
| 9 | HWLN38 | 3/8" NYLOK NUT ZINC | 2 |
| 10 | HWCB516212 | 5/16"-18 x 2-1/2" CARRIAGE BOLT | 8 |
| 11 | HWTEX1034 | #10 X 3/4" SELF DRILLING SCREW TEK POINT ZINC | 20 |
| 12 | HWHB381 | 3/8" x 1" HEX BOLT | 2 |
| 13 | CIPICTAB8 | 1" O.D. GALV. SUPPORT BRACE | 2 |
| 14 | VCIAECP | 2"x10" ALUMINUM END CAP | 10 |
| 15 | WTPAJFRAME | J-FRAME ASSEMBLY | 2 |

| | | |
|---|---------------|-------------------------|
|  <p>Steelcraft ELEMENTS FOR LIFE OUTSIDE® www.LASTEELCRAFT.com 1-800-371-2438</p> | Date: 6/20/23 | PRODUCT NAME |
| | Rev: | 8' ALUMINUM PLANK TABLE |
| | Drawn: CW | MODEL NO. |
| | Sheet: 4 of 4 | TPA-8A-SPEC |