

STEELCRAFT PRODUCTS

P.O. Box 90365 - Pasadena, CA 91109
PHN 626-798-7401 FAX 626-798-1482

MODEL
-13
TEMPERED GLASS
BACKBOARD

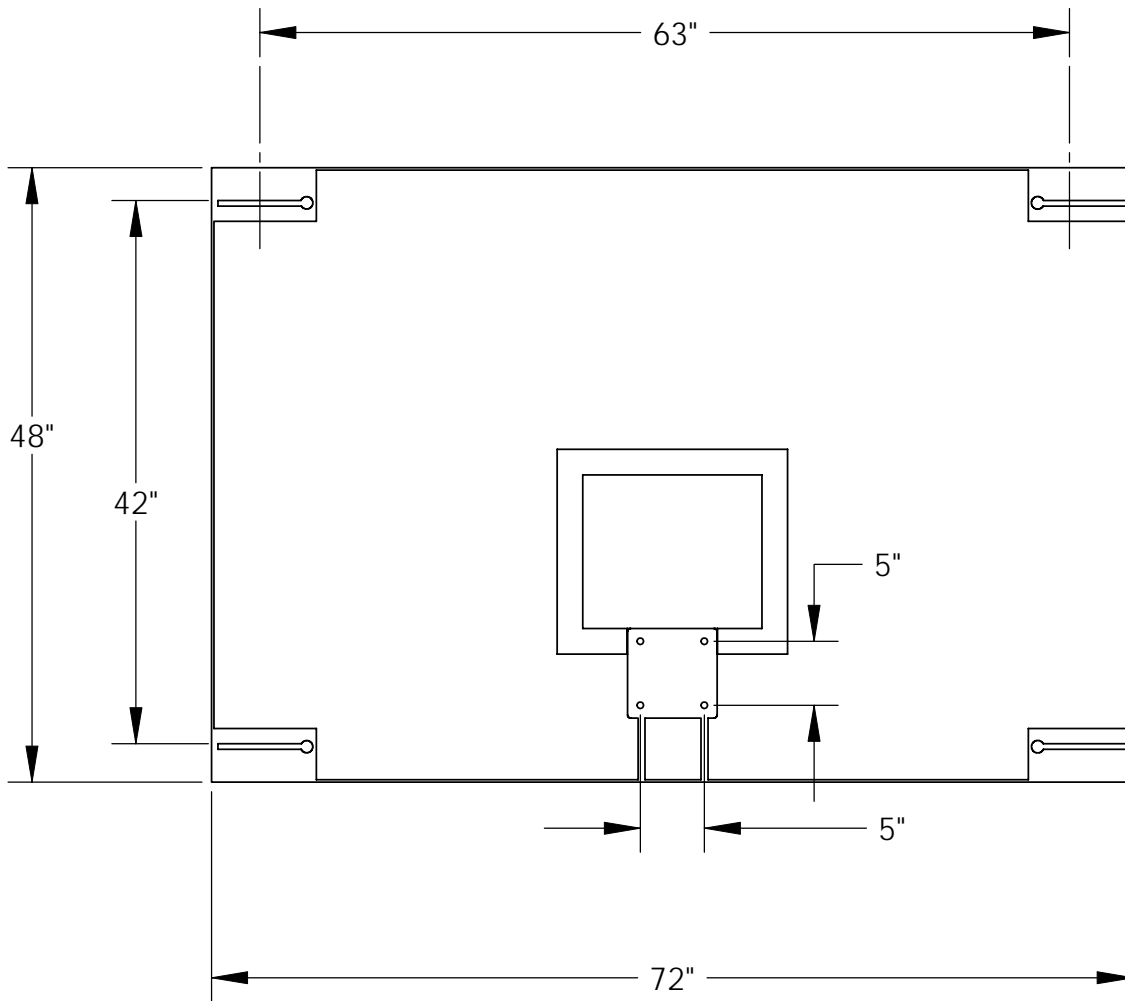

BACK VIEW

NOTES:

- BACKBOARD THICKNESS: 2-1/4"
- MATERIAL: 1/2" THICK TEMPERED GLASS, OUTSIDE FRAME IS ANODIZED ALUMINUM
- FINISH: GRAY POWDERCOAT ON BRACKETS AND PLATES
- KEY HOLE BRACKETS ARE MOUNTED IN THE CORNERS FOR BRACING. HOLE PATTERN FOR GOAL RIM IS 4" X 5"
- WEIGHT: 240 LBS.

NOTE: SPECIFICATIONS ARE SUBJECT TO CHANGE

DO NOT SCALE DRAWING

DATE: 9/22/08

DRAWN BY: AFS